

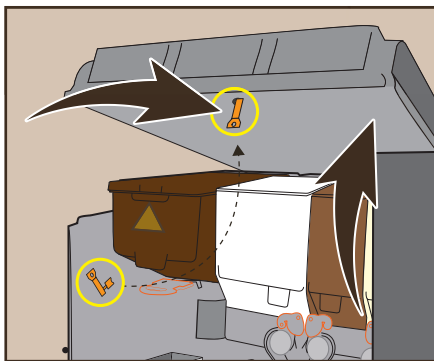

# multiBona3

## Cleaning Instructions

1 x daily cleaning (max. 7 minutes)



- 1 Open the machine door.  
Remove the service key from the holder on the left wall of the housing and start up the machine.

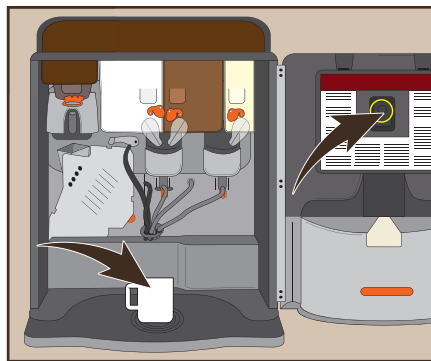

- 2 Place the rinsing cup under the spout. Then press the program button in the door.

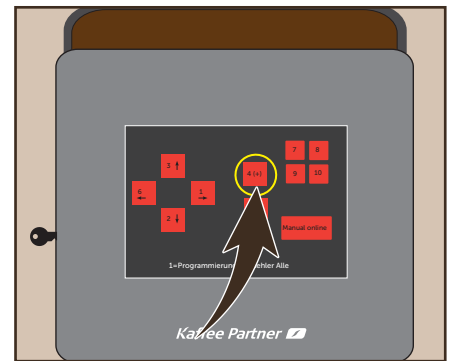

- 3 Press button 4 to select the rinsing program. Press button 10 to confirm that the drip pan is empty. Press button 10 to confirm that the water is OK.

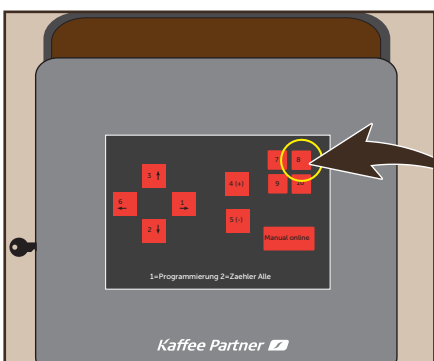

- 4 Overall rinsing program  
Press button 8 to start the overall rinsing program. (4:30 min) Follow the instructions on the display. Insert the Kaffee Partner cleaning tablet into the funnel and confirm by pressing button 10.

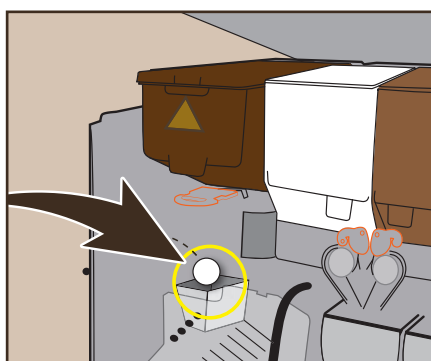

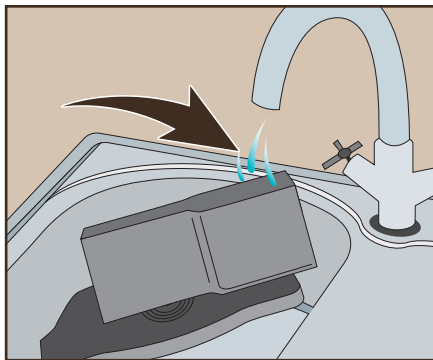
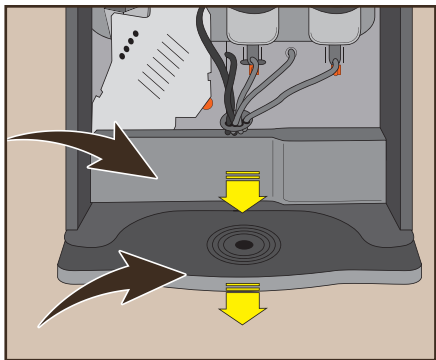

**5 Clean the trash bin and drip pan:**  
With the machine door open, remove the trash bin and drip pan forwards. Empty the coffee grounds and water.

**6** Rinse both under running water, and reinsert.

## 1 x weekly cleaning (max. 10 minutes)

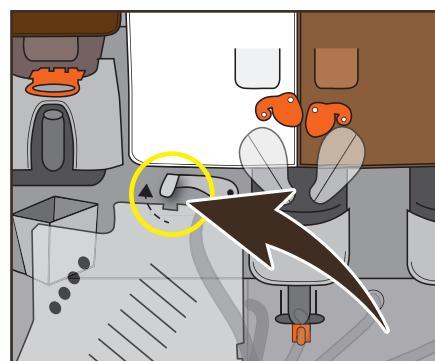
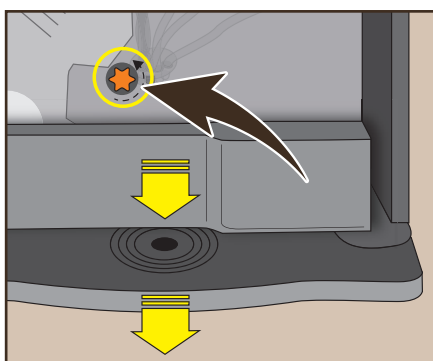
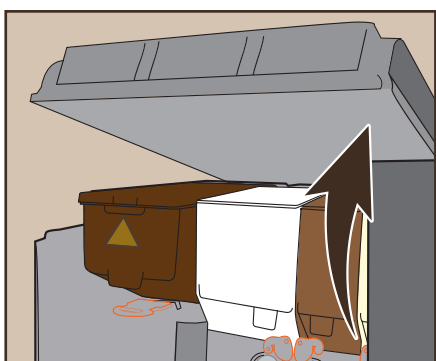

**1** Open the machine door.

**2** Remove the trash bin and drip pan and unscrew the orange screw cap.

**3** Push the brewer's retaining brackets upwards.

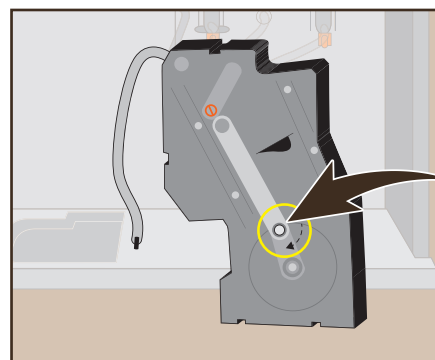
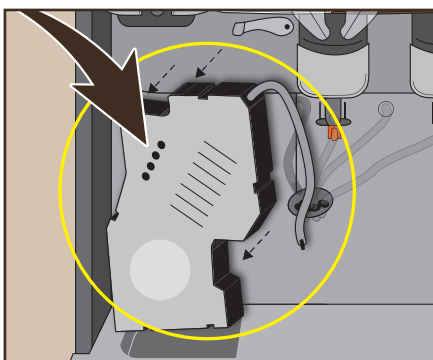
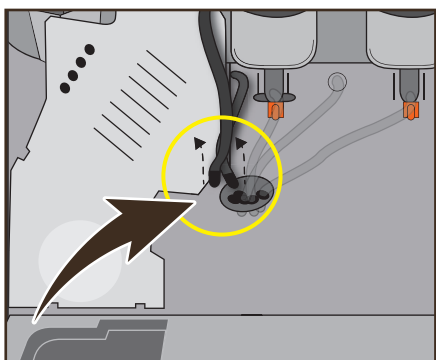

**4** Remove the delivery tube on the left and the coffee tube directly next to it, and allow them to hang down loosely.

**5** Remove the brewer at an angle forwards.

**6** Push down the bolts for the crank drive on the back of the brewer.

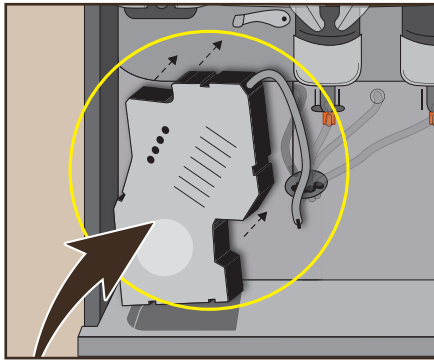

7 Clean the coffee strainers under running water and thoroughly dry the brewer. Install the brewer in reverse order between the red retaining lugs.

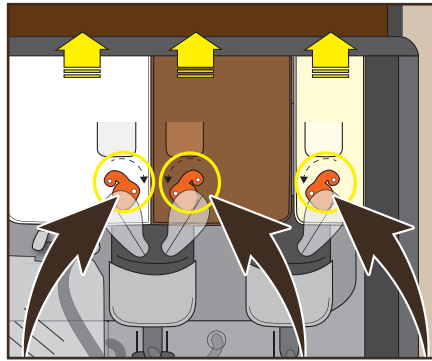

8 Close all 3 product containers with a sealing cap and remove them upwards.

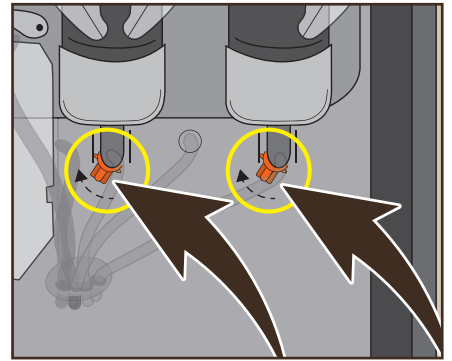

9 Push the two red bayonet locks up approx. 30 degrees clockwise.

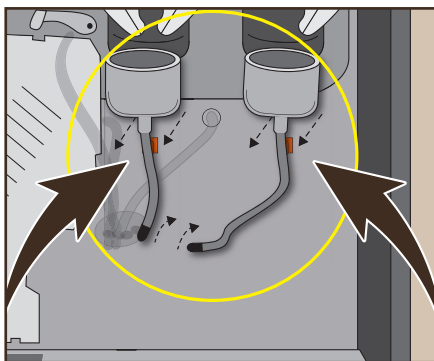

10 Fully release both tubes at the delivery outlet. Remove the complete mixer and tube forwards.

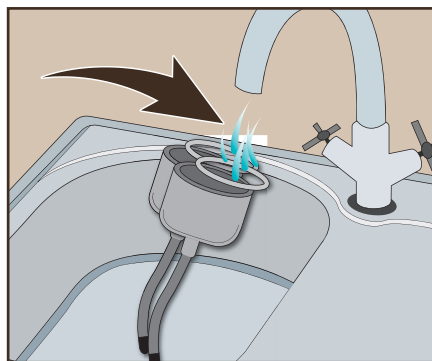

11 Clean the mixer thoroughly under running water. **Thoroughly dry the mixer.** Reassemble the parts in reverse order.

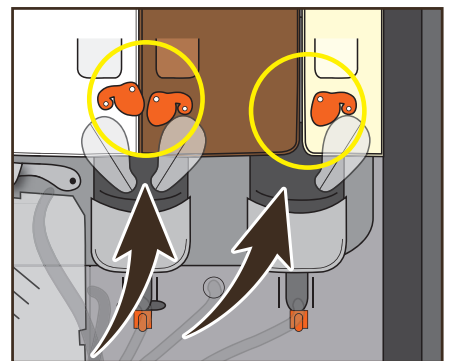

12 Caution: Open the covers of the 3 product containers. 

**Note:** Only use a dry, antistatic microfibre cloth to clean the touch screen. Never use cleaning agents containing alcohol, solvents or abrasive substances.

Order special cleaning agents and accessories at:

 [www.kaffee-partner-shop.de](http://www.kaffee-partner-shop.de)

 [www.kaffee-partner-shop.at](http://www.kaffee-partner-shop.at)

 [www.kaffee-partner-shop.ch](http://www.kaffee-partner-shop.ch)



# Emergency Service

Don't panic if something goes wrong.  
The key error messages at a glance:

Display	Cause	Solution (Always restart your machine afterwards)
Service OFF 3	The drip pan is full. The drip pan sensor has tripped.	Remove the drip pan. Empty the drip pan. Reinstall the drip pan.
No Water OFF 6	No water to fill the machine. The water tank is empty. The water supply is insufficient.	Top up with water. Reconnect the water supply. Reset by pressing button 1.
Service OFF 8	The brewer is blocked. The brewing time has been exceeded. The grind is too fine.	Clean the brewer.
No Coffee OFF 8 B	The brewer has not been installed properly. The metal bracket that holds the brewer in place is not locked in place correctly.	Completely remove the brewer and reinsert it, then push the metal bracket as far as it will go.
No Coffee OFF 8 C	The brewer has been incorrectly installed The orange screw cap is tilted or not sufficiently screwed on.	Completely remove the orange screw cap and re-tighten it straight.
No Coffee OFF 9	The grinder is getting no or not enough beans. 1. The bean container is empty. 2. The slide below the bean container is not fully open. 3. A bean has become jammed in the grinder.	1. Refill beans. 2. Pull the slide under the bean container all the way forward. 3. Push the slide all the way into the machine, remove the bean container and remove any stuck beans from the grinder.  <b>Important: switch off the machine!</b>
Replace the water filter	The water filter needs to be changed.	Open the door. Insert the door contact key. Wait until the error is displayed again. Press the program button. Press button 5 then 2 on the outside, and confirm with the program button.



Service Hotline  
+49 (0) 541 75045-400



Support email  
support@kaffee-partner.de



Product Ordering Hotline  
+49 (0) 541 75045-100

**Kaffee Partner**

Kaffee Partner GmbH  
Kaffee-Partner-Allee 1  
49090 Osnabrück · Germany  
www.kaffee-partner.de



Service Hotline  
+43 (0) 662 2682-37



Support email  
support@kaffee-partner.at



Product Ordering Hotline  
+43 (0) 662 2682-35

**Kaffee Partner**

Kaffee Partner Austria GmbH  
Himmelreich 1  
5020 Salzburg · Austria  
www.kaffee-partner.at



Service Hotline  
+41 (0) 41 74100-52



Support email  
support@kaffee-partner.ch



Product Ordering Hotline  
+41 (0) 41 74100-50

**Kaffee Partner**

Kaffee Partner Schweiz AG  
Hinterbergstrasse 24  
6312 Steinhausen · Switzerland  
www.kaffee-partner.ch